



**cruce mundo**

Travessera de les Corts, 348/4  
08029 Barcelona, Spain  
T +34 934542041  
F +34 937060067  
www.cruceundo.com

**MS CRUCEBELLE 4\***

Technical and service characteristics



**technical information:**

built in	2000
refurbished	2018-2019 (French balconies on Middle, Upper deck)
length	110m
width	11,4m
cabins #	77
passengers	154pax
crew	35pax

**Upper deck**

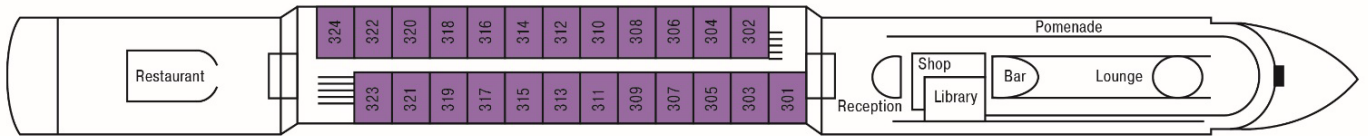

**Middle deck**



**Middle Front deck**

**Main deck**

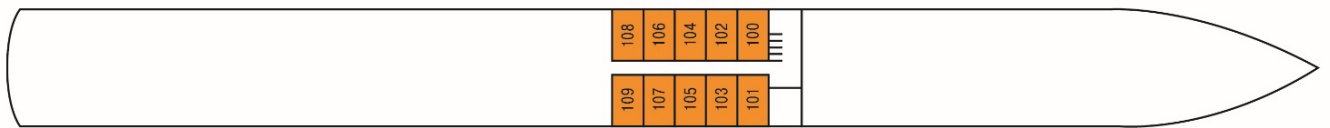

Standard cabin  
Main Deck



Standard cabin  
Middle Front Deck



Deluxe cabin  
Middle Front Deck



Deluxe cabin  
Middle Deck



Deluxe cabin  
Upper Deck



**accommodation:**

**standard main deck**

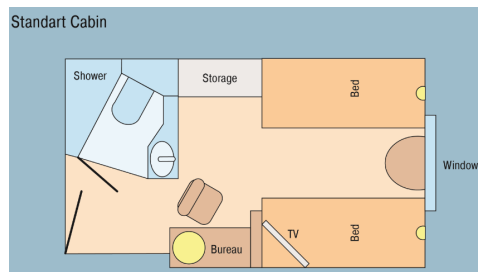

**size:** 11m<sup>2</sup>

**equipment:** private facilities, satellite TV, hairdryer, safe, internal phone

**windows:** smaller fixed window, does not open

**bed configuration & size:** twin only, 205cm \* 85cm \* 40cm (one of beds is transformed into the sofa during the day time, and another one is folded)

**outlet:** 2 regular outlets (1 under the TV, 1 at the window), 1 with 115V (American)

**standard middle front deck**

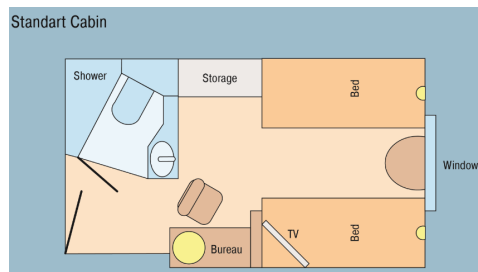

**size:** 11m<sup>2</sup>

**equipment:** private facilities, satellite TV, hairdryer, safe, internal phone

**windows:** fixed window, does not open

**bed configuration & size:** twin only, 205cm \* 85cm \* 40cm (one of beds is transformed into the sofa during the day time, and another one is folded)

**outlet:** 2 regular outlets (1 under the TV, 1 at the window), 1 with 115V (American)



**cruce mundo**

Travessera de les Corts, 348/4  
08029 Barcelona, Spain  
T +34 934542041  
F +34 937060067  
www.crucemundo.com

**MS CRUCEBELLE 4\***

Technical and service characteristics

deluxe middle front deck (#218)

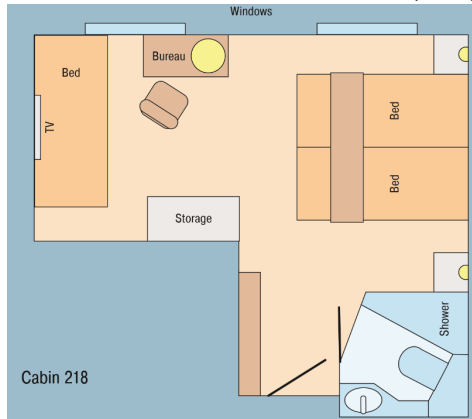

**size:** 16m<sup>2</sup>

**equipment:** private facilities, satellite TV, hairdryer, safe, internal phone

**windows:** large picture window, does not open (225cm wide \* 120cm high; 70cm from the floor)

**bed configuration & size:** twin or double, sofa (can be used as a 3<sup>rd</sup> bed) 200cm \* 80cm \* 55cm (each part; 200cm \* 160cm \* 55cm when double)

**outlet:** 2 regular outlets (1 under the TV, 1 at the window), 1 with 115V (American)

deluxe middle deck \*shown as double

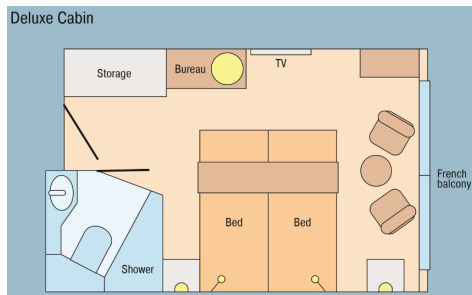

**size:** 14m<sup>2</sup>

**equipment:** private facilities, satellite TV, hairdryer, safe, internal phone

**windows:** French balcony

**bed configuration & size:** twin or double, 200cm \* 80cm \* 55cm (each part; 200cm \* 160cm \* 55cm when double)

**outlet:** 2 regular outlets (1 under the TV, 1 at the window), 1 with 115V (American)

deluxe upper deck \*shown as twin

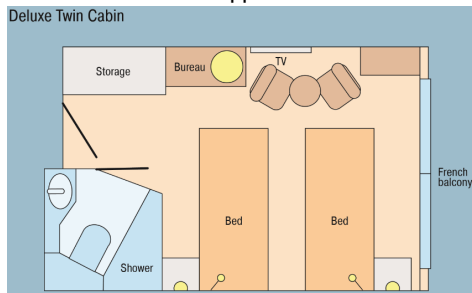

**size:** 14m<sup>2</sup>

**equipment:** private facilities, satellite TV, hairdryer, safe, internal phone

**windows:** French balcony

**bed configuration & size:** twin or double, 200cm \* 80cm \* 55cm (each part; 200cm \* 160cm \* 55cm when double)

**outlet:** 2 regular outlets (1 under the TV, 1 at the window), 1 with 115V (American)

**facilities:**

lift	<b>dimensions:</b> 110cm * 140cm * 210cm
restaurant	<b>connection:</b> main, middle and upper decks
lounge	<b>capacity:</b> 154pax
bike rental	<b>quantity:</b> 5 bikes

**service:**

wi-fi	<ul style="list-style-type: none"> <li>• 1-hour for € 5,00</li> <li>• 3-hours for € 12,50</li> <li>• 24-hours for € 19,50</li> <li>• Total cruise package</li> </ul> Price for up to 7 nights is € 47,50, every additional night costs € 7,00 <b>Condition:</b> must be purchased for the complete duration of the cruise
luggage service	pier – ship – pier
check in	16:00
welcome buffet	welcome soup and sandwiches are offered in the lounge on embarkation day (~15:00-16:00)
luggage service	pier – ship – pier
coffee-station	available on a daily basis from an hour before breakfast until dinner time; includes all items such as hot water, tea bags, sugar, different types coffee such as latte, cappuccino, also hot chocolate (self-service coffee machine)
linen change	once a week (7-nights' cruise)
early risers breakfast	tea, coffee, orange juice, Danish pastries (served before breakfast)



**cruce  
mundo**

Travessera de les Corts, 348/4  
08029 Barcelona, Spain  
T +34 934542041  
F +34 937060067  
www.crucemundo.com

**MS CRUCEBELLE 4\***

Technical and service characteristics

afternoon coffee-and-cake and/or late-night snacks	offered daily
bar opening hours	end of breakfast – midnight
payment	made in cash or with credit card Visa/MasterCard/Maestro
check out	09:00
	tap water for lunch and dinner
	welcome drinks